

Tools Required

- #2 and #3 Phillips Head 
- Drill 

Kit Content: Base Kit

1. End base unit
2. Mid base unit
3. Stretcher rails
4. Glides
5. Cam screws
6. Cam lock nuts
7. Mounting plate screws (Top Assembly)
#10 x 1" pan head screw
8. Stretcher rail screws for Top (Top Assembly)
#8 x 1-1/2" pan head screw

Bevel Base - Installation Notes

1. **Stretcher Rail Orientation:** Position the **Stretcher rails (3)** so that the screw holes are facing inward and upward within the table structure.
2. **Glide Installation:** Insert **Glides (4)** into the bottom of each **End base (1)** and **Mid base (2)** before attaching the **Stretcher rails (3)**. This will ensure stability and floor protection.
3. **End Base Orientation:** Align the **End bases (1)** facing toward the center of the table with the **Cam screws (5)** facing inward.

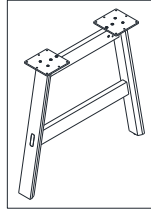

(1) End base unit

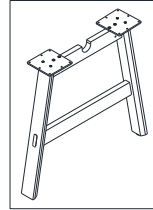

(2) Mid base unit

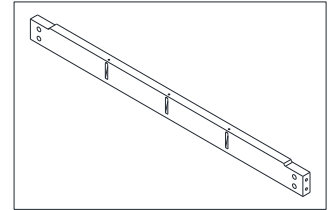

(3) Stretcher rails

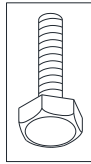

(4) Glides

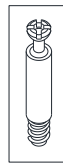

(5) Cam screws

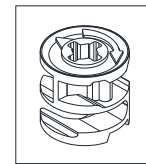

(6) Cam lock nuts

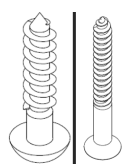

(7,8) Screws

Installation Notes

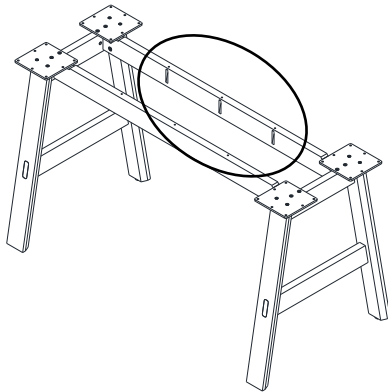

(1) Stretcher Rail Orientation

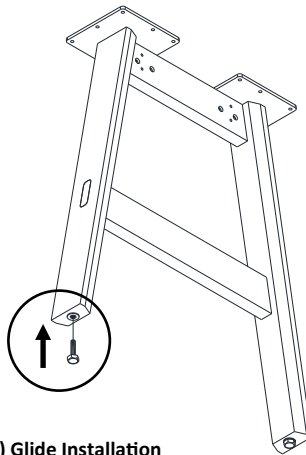

(2) Glide Installation

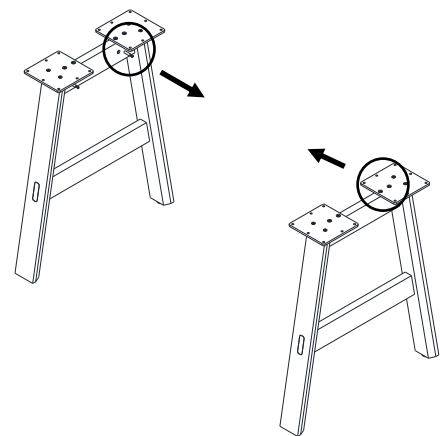

(3) End Base Orientation

Bridge Base: 2 Base — 3 Base — 4 Base

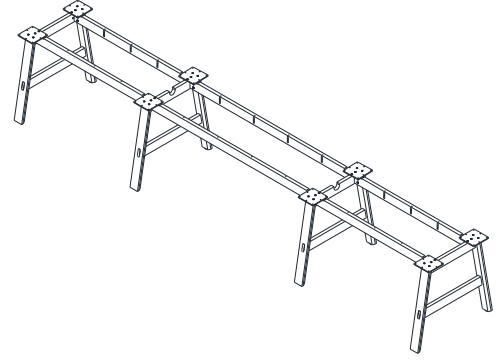
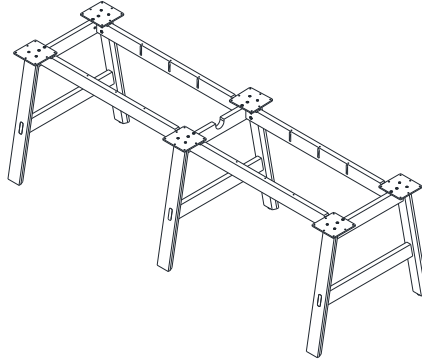
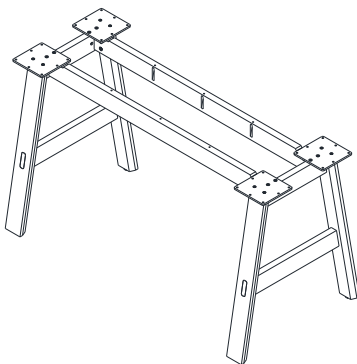

Bridge Base — 2 Base Kit

1. Insert **Glides (4)** into bottom of each base and fasten to desired height.

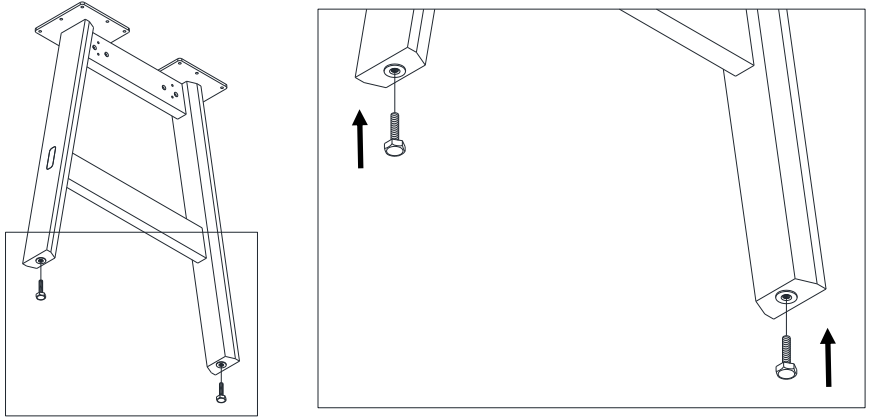

2. Insert **Cam screws (5)** into the top of each base.

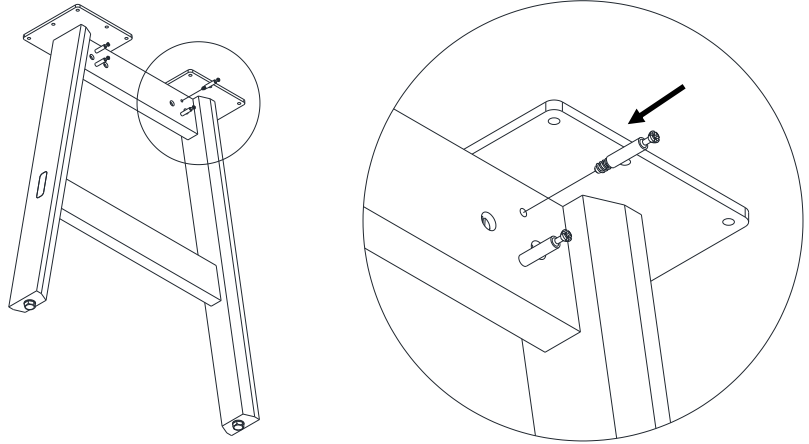

3. Align the **End bases (1)** facing toward the center of the table with the **Cam screws (5)** facing inward.

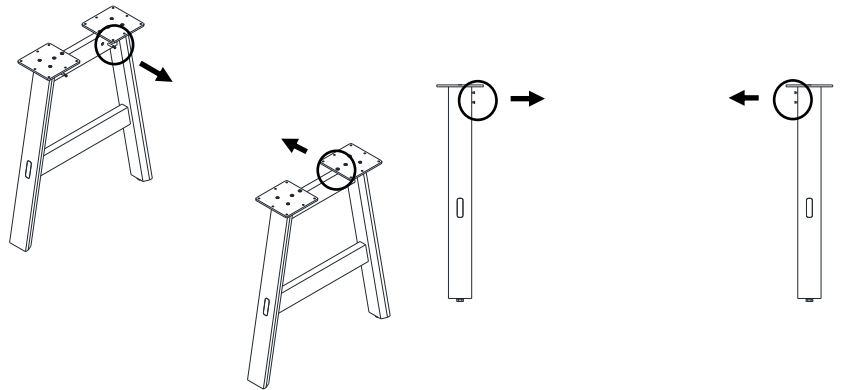

4. Position the **Stretcher rails (3)** so that the screw holes are facing inward and upward within the table structure.

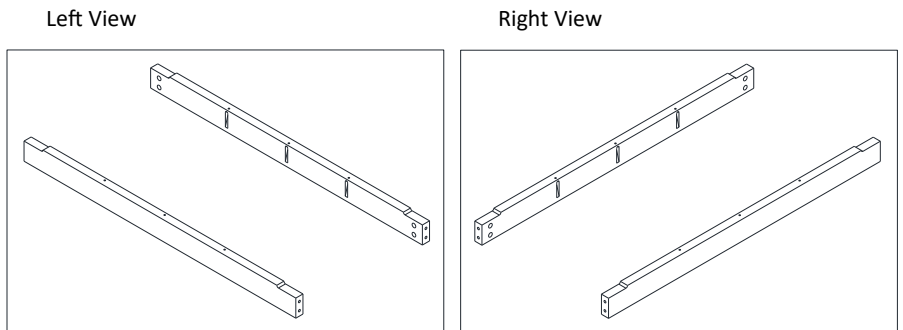

Bridge Base — 2 Base Kit Continued...

5. Insert the **Cam screws (5)** on the base into the holes on the end of the **Stretcher rails (3)**.

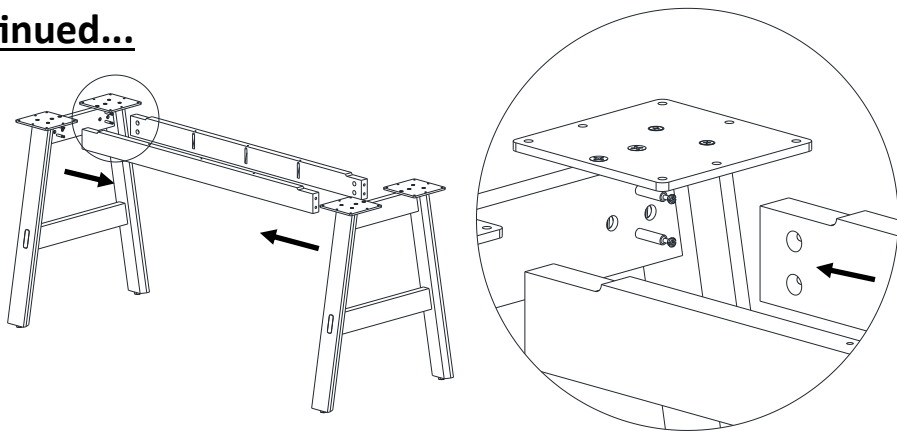

6. Insert **Cam lock nuts (6)** through the stretcher rail holes and fasten securely.
7. Repeat this process on all four stretcher rail holes.

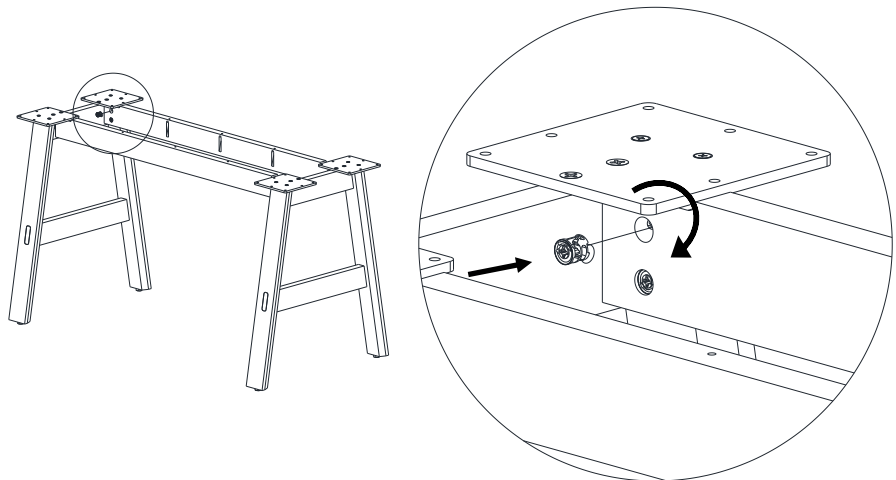

Bridge Base — 3 Base Kit

1. Insert **Glides (4)** into bottom of each base and fasten to desired height.

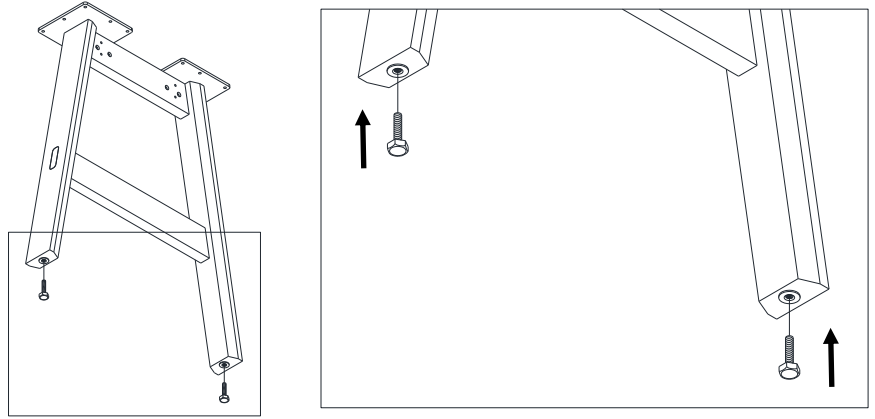

2. Insert **Cam screws (5)** into the top of each base.

NOTE: **Mid base units (2)** will have 8x **Cam screws (5)** in total. There will be 4x **Cam screws (5)** on each side of the base.

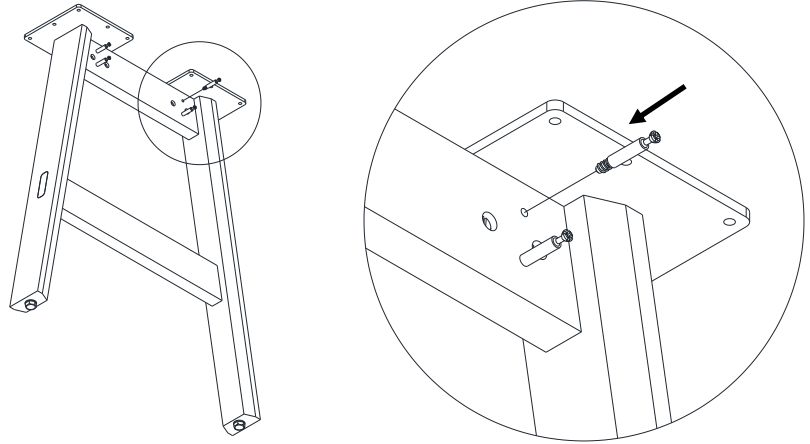

3. Align the **End bases (1)** facing toward the center of the table with the **Cam screws (5)** facing inward.
4. Align **Mid base unit (2)** between the **End base units (1)**—either direction.

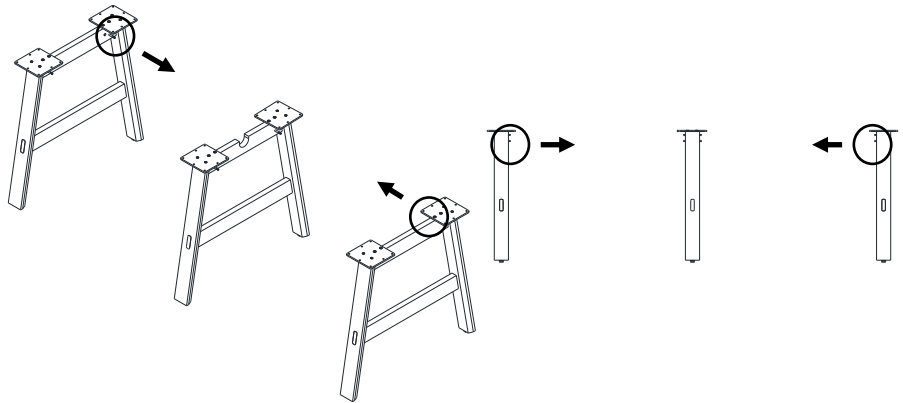

5. Position the **Stretchers rails (3)** so that the screw holes are facing inward and upward within the table structure.
6. Repeat this process for all 4x **Stretchers rails (3)**.

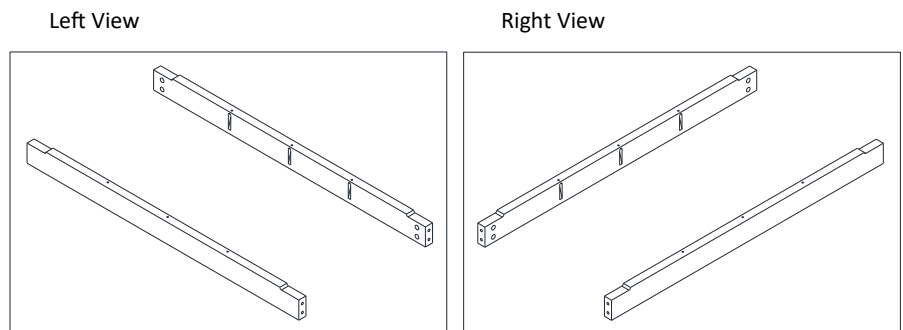

Bridge Base — 3 Base Kit Continued...

7. Insert the **Cam screws (5)** on the base into the holes on the end of the **Stretcher rails (3)**.

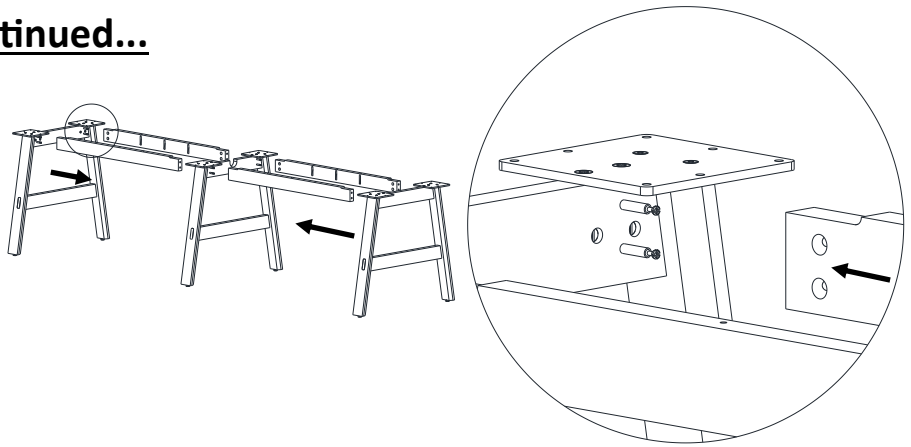

8. Insert **Cam lock nuts (6)** through the stretcher rail holes and fasten securely.
9. Repeat this process on all four stretcher rail holes.

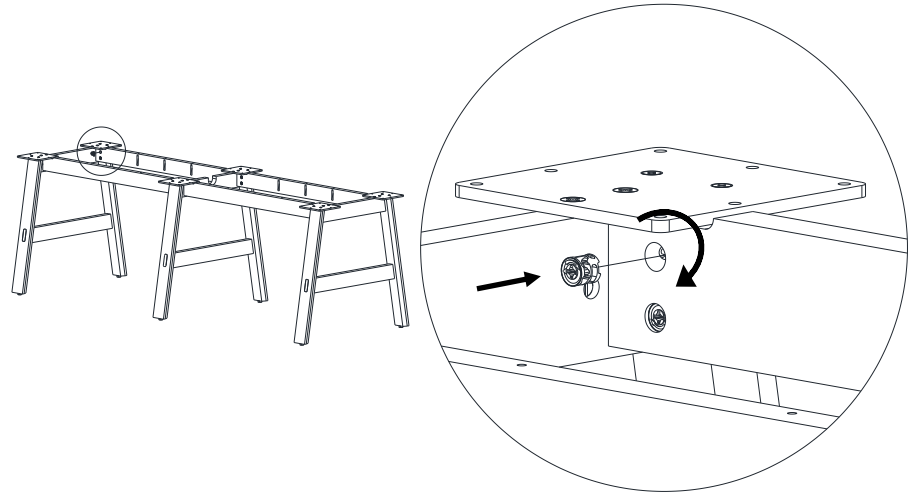

Bridge Base — 4 Base Kit

1. Insert **Glides (4)** into bottom of each base and fasten to desired height.

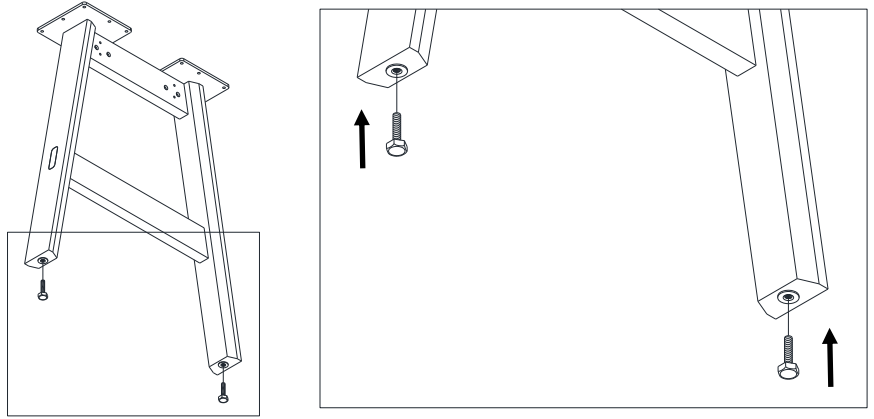

2. Insert **Cam screws (5)** into the top of each base.

NOTE: **Mid base units (2)** will have 8x **Cam screws (5)** in total. There will be 4x **Cam screws (5)** on each side of the base.

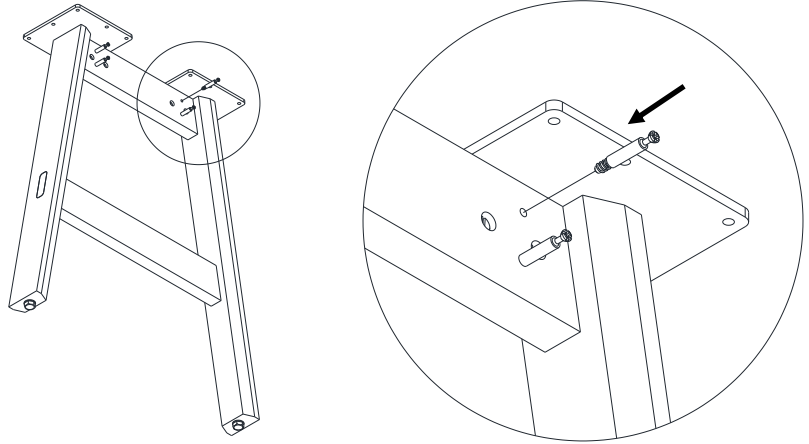

3. Align the **End bases (1)** facing toward the center of the table with the **Cam screws (5)** facing inward.
4. Align **Mid base units (2)** between the **End base units (1)**—either direction.

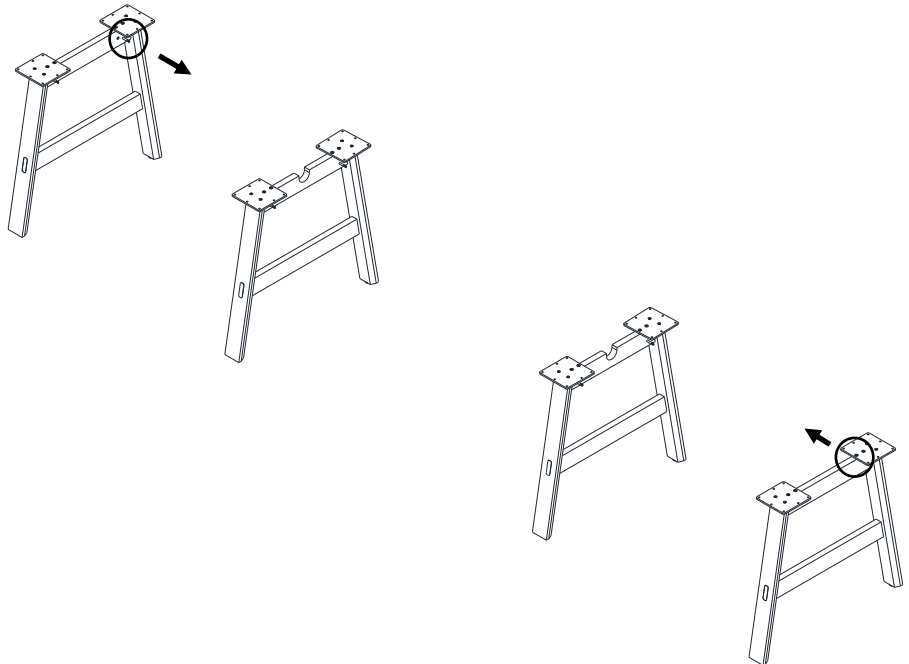

Bridge Base — 4 Base Kit Continued...

5. Position the **Stretcher rails (3)** so that the screw holes are facing inward and upward within the table structure.
6. Repeat this process for all 6x **Stretcher rails (3)**.

Left View

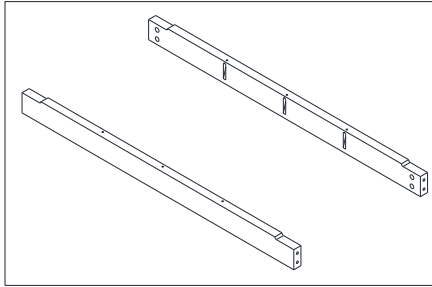

Rail Orientation

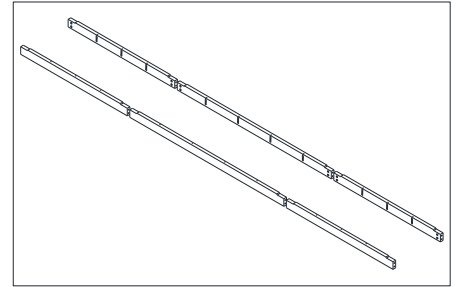

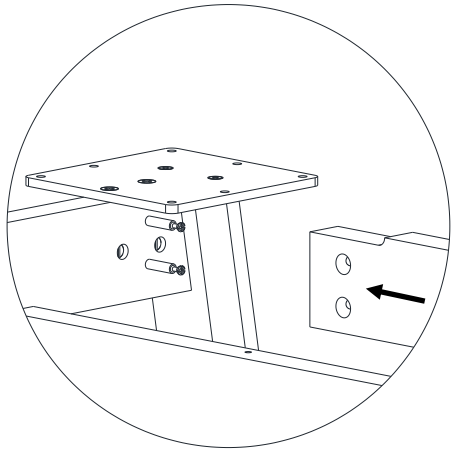
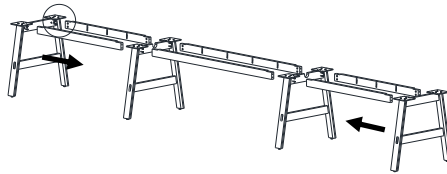

7. Insert the **Cam screws (5)** on the base into the holes on the end of the **Stretcher rails (3)**.

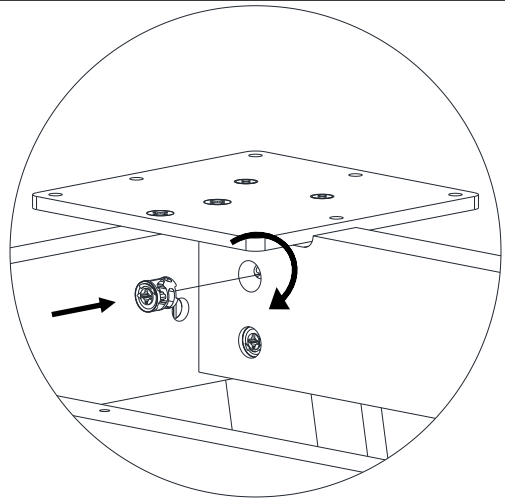
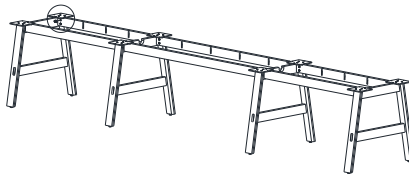

8. Insert **Cam lock nuts (6)** through the stretcher rail holes and fasten securely.
9. Repeat this process on all four stretcher rail holes.

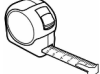

Tools Required

- #2 Phillips Head 
- Drill 
- Measuring Tape 
- Level (optional for precision)

Kit Content: Top Kit

1. 1-Piece Top
2. 2-Piece Top
3. 3-Piece Top

Screws — Base Kit

7. Mounting plate screws (Top Assembly)
#10 x 1" pan head screw
8. Stretcher rail screws for Top (Top Assembly)
#8 x 1-1/2" pan head screw

Table Top Installation Notes

All Tops: center on base and attach to base with

Mounting plate screws (7).

- Use **Stretcher rail screws (8)** to attach stretcher rails to top.

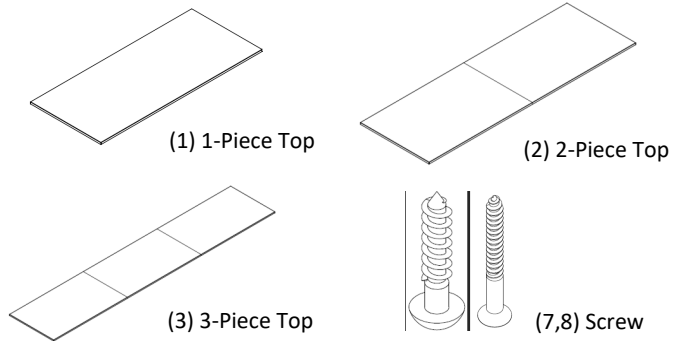

Step 1: Positioning the Tabletop and Bases

1. Center the assembled base kit under the table top.
2. Verify top is centered using **Measuring Tape**.
 - Measurement 1 and 2 are equal
 - Measurement 3 and 4 are equal
3. Follow same centering process for **3-Base Kit** and **4-Base Kit**.

NOTE: Make all measurements from **End base units**.

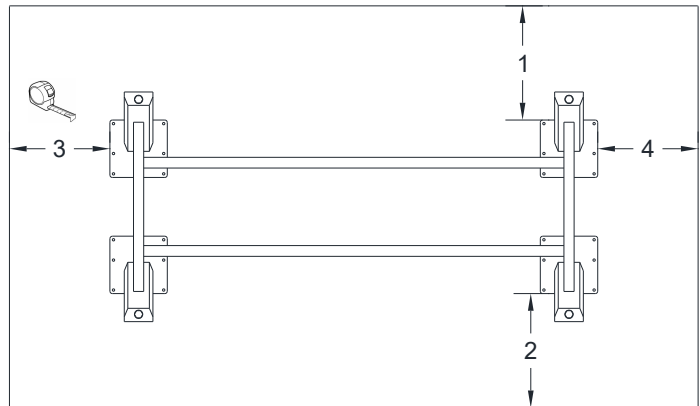

Step 2: Verify each Mid Base Unit sits under Tabletop seam

